

SHEET 120

SHEET 125

SHEET 123

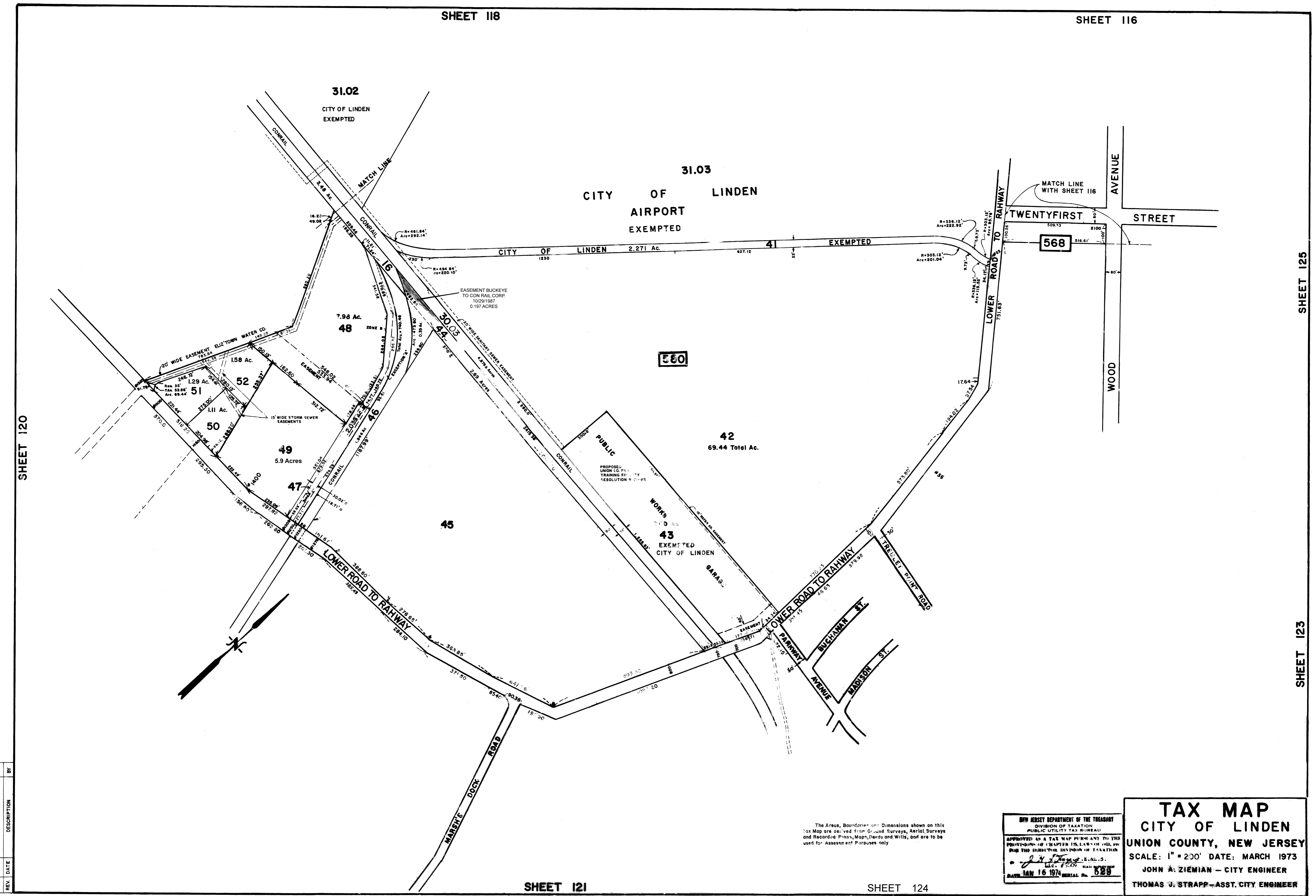

REV.	DATE	DESCRIPTION	BY

The Areas, Boundaries and Dimensions shown on this Tax Map are derived from Ground Surveys, Aerial Surveys and Recorded Plans, Maps, Deeds and Wills, and are to be used for Assessment Purposes only.

NEW JERSEY DEPARTMENT OF THE TREASURY
 DIVISION OF TAXATION
 PUBLIC UTILITY TAX BUREAU
 APPROVED AS A TAX MAP PURSUANT TO THE
 PROVISIONS OF CHAPTER 175, L.A.S. 1972, AND
 CHAPTER 175, L.A.S. 1973.
 JOHN A. ZIEMIAN, C.E.
 DATE JAN 16 1974 SERIAL No. 588

TAX MAP
CITY OF LINDEN
 UNION COUNTY, NEW JERSEY
 SCALE: 1" = 200' DATE: MARCH 1973
 JOHN A. ZIEMIAN - CITY ENGINEER
 THOMAS J. STRAPP - ASST. CITY ENGINEER

SHEET 121

SHEET 124